

TE 640 3D FR

with integrated intumescent kit for unrebated high performance heavy-duty doors



Product features

- with integrated intumescent kit
- completely concealed hinge system
- for timber, steel or aluminium frames
- for unrebated high performance heavy-duty doors
- sideways closed hinge body for a homogeneous mortise appearance
- comfortable 3D adjustment (side +/- 3.0 mm, height +/- 3.0 mm, compression +/- 1.0 mm)
- maintenance-free slide bearings

Technical data

Property	Value
Load capacity	200.0 kg
Overall length	240.0 mm
Width (door part)	32.0 mm
Width (frame part)	32.0 mm
Cutter diameter	24.0 mm
Collar ring diameter	30.0 mm
Opening angle	180°

Quality marks

 CE certification

 IFT certification

 Warringtonfire certification

 Certifire certification

 UKCA certification

Classification code

4	7	7	1 <sup>*1</sup>	1	— <sup>*2</sup>	1	14
---	---	---	-----------------	---	-----------------	---	----

<sup>\*1</sup> Test evidence for functional doors to be achieved with full door sets and assemblies.

<sup>\*2</sup> depending on the finish

**TECTUS - TE 640 3D FR****Notes**

The load capacity mentioned above refers to the use of 2 hinges per door leaf (1 x 2 m), for detailed information please look at the chapter [technical information](#).

With an opening position of 180° the door may have to be fixed additionally.

The suitability for fire doors depends on the door construction.

Other finishes on request.

**Installation tools**

Universal milling frame

Template 5 250659 5

Template 5 250689 5

step 1

step 2

**Combinations**

TE 640 3D FZ

TE 640 3D SZ

TE 640 3D ST

**Function range**

Burglar  
resistance



Fire resistance



Smoke  
resistance



Soundproof

**Item versions**

Finish

Satin Chrome Look  
(F1) (SW 124)

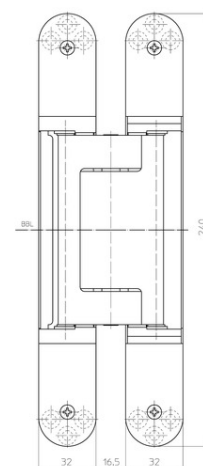

front view

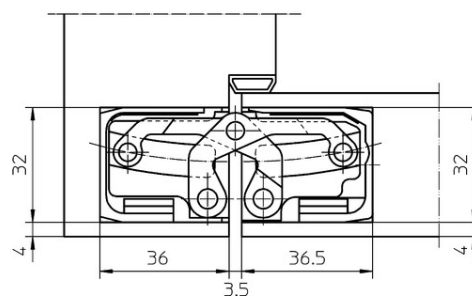

block frame

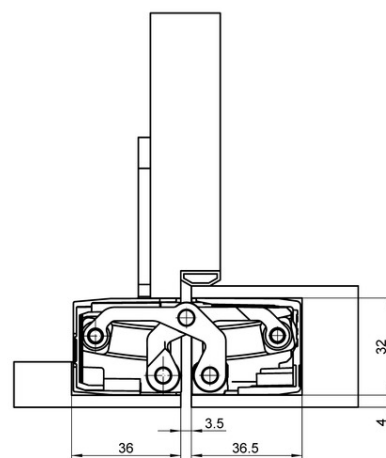

casing frame

**TECTUS - TE 640 3D FR**

VPE	Pack of 2
DIN	DIN right and left hand
Article number	5 400703 0 12402
EAN	4015471128609

Finish	Stainless Steel Look (SSL) (SW 126)
VPE	Pack of 2
DIN	DIN right and left hand
Article number	5 400703 0 12602
EAN	4015471128715

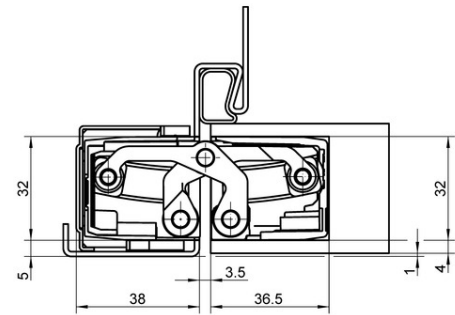

steel frame